

Low Profile Series Fan Powered Air Terminal Unit With Hot Water Coil

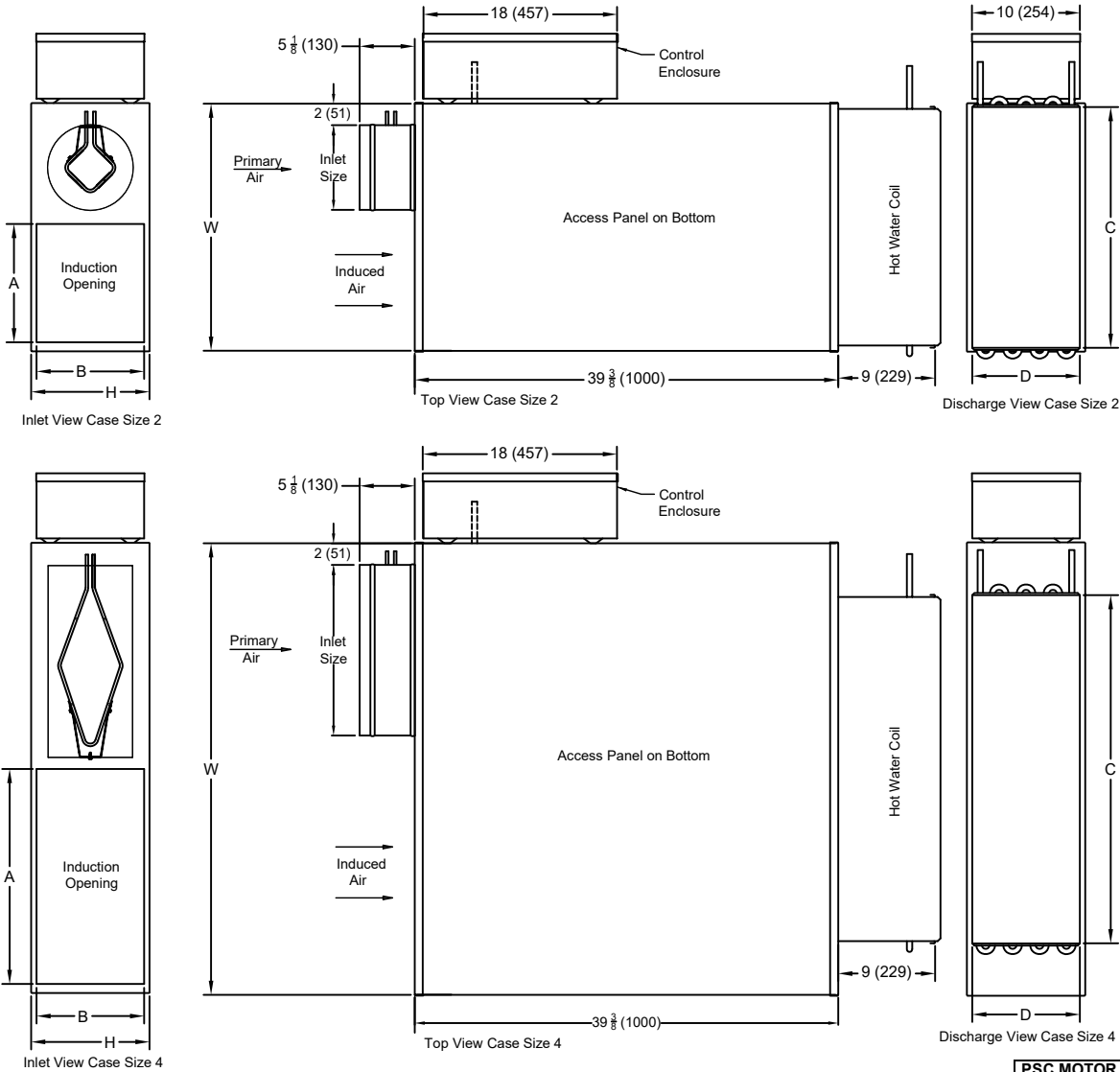

The standard location for control enclosure is Left Hand. Looking in the direction of airflow, the control enclosure is on the left.

Case size 4 includes two discharge blowers

All Dimensions shown in inches, parentheses () indicate millimeter

Optional Inlet Sizes 4,5 and 6. Available On Case Size 2 Only

Case Size	Inlet Size Standard	Unit Width W	Unit Length L	Unit Height H	Induction		Discharge	
					Width A	Height B	Width C	Height D
2	8 (203) Round	23 (584)	39 (991)	11 (279)	10 1/2 (267)	8 1/2 (216)	22 (559)	10 1/2 (267)
4	8 (203) x 16 (406) Rect.	42 (1067)	39 (991)	11 (279)	18 (457)	8 1/2 (216)	32 (813)	10 1/2 (267)

PSC MOTOR CONFIGURATION	
Case Size	Horse Power
2	1/4
4	1/4 (QTY 2)

ECM MOTOR CONFIGURATION	
Case Size	Horse Power
2	1/3
4	1/3 (QTY 2)

Standard Construction

- 1/2" Dual Density, Coated Fiberglass
- All Insulations Meet NFPA 90A And UL181
- All Fiberglass Insulations Have Coated Edges To Prevent Fiber Migration
- Units Are Constructed With 22 Gauge Casing and 18 Gauge Discharge
- 18 Gauge Equivalent Damper Assembly with Integral Blade Seal
- 18 x 10 Control Enclosure
- Slip & Drive Discharge Connection
- Optional Induction Attenuator
- Inlet Flow Sensor